

6 C" Brushaway Filter In-Line ISO-16 RED 130Mic

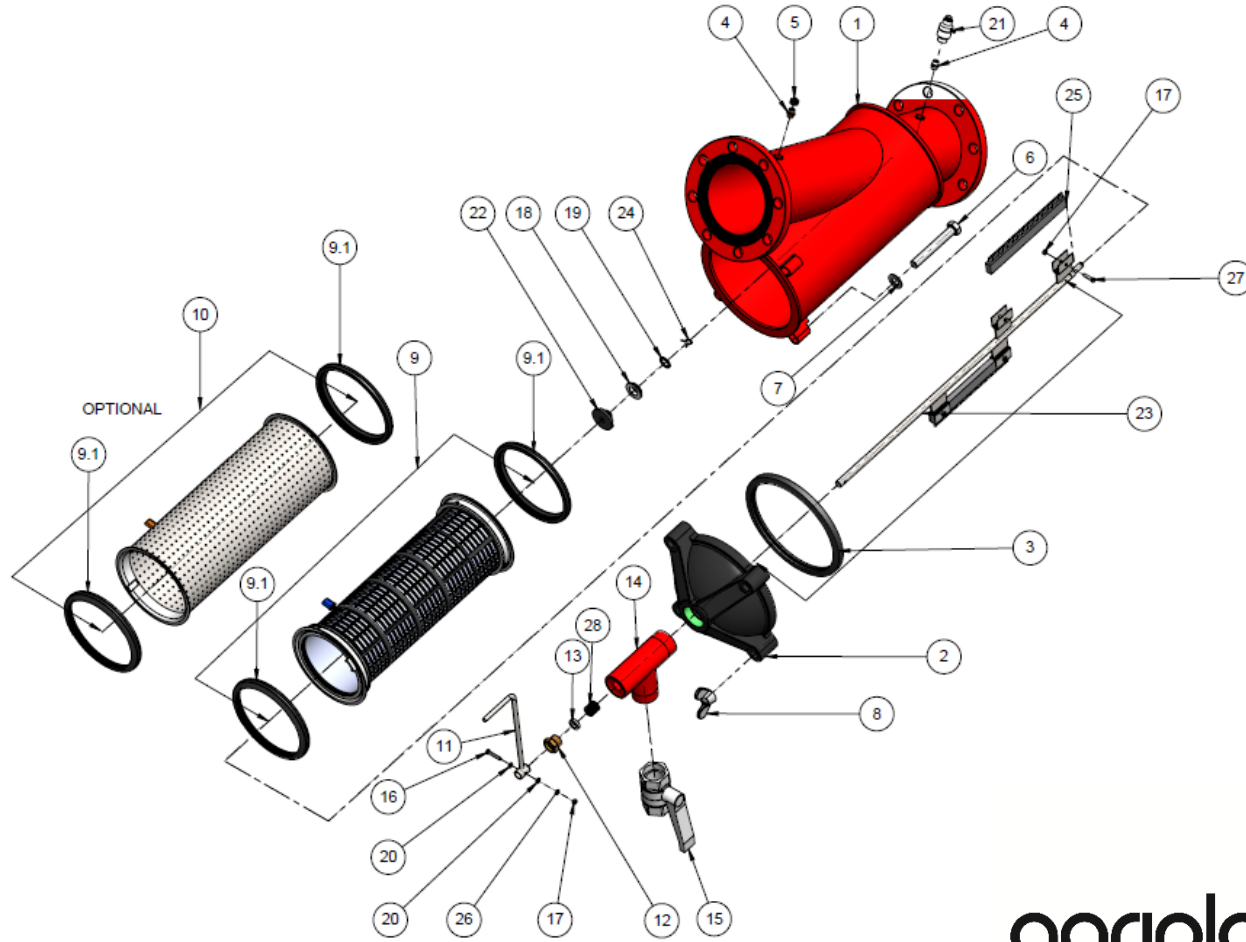

ITEM NO.	CAT. NO.	DESCRIPTION	QTY.	MATERIAL
1	710105-000196	6"Metal Housing JAD PKPK 3002	1	ST 37-2
2	710103-000679	Lid Polyester 6"-14" With 2" Threads	1	PE-100
3	770104-000089	Hydraulic Seal AM-07 (Polyester Lid)	1	NBR
4	710103-000591	Pressure Check Point Connector 1/4"X1/4"	2	Brass
5	700190-001305	Pressure Check Point Plastic W/O Nipple	1	Various
6	760101-000297	Hex.Bolt 3/4"UNC	4	Z.Plated C/ST
7	760103-000070	Flat Washer M20 DIN125 Zinc Plated C/ST	4	Z.Plated C/ST
8	760102-000076	NUT WING TYPE A 3/4"UNC M/S GALV	4	Z.Plated C/ST
9	700101-000489	MOLDED ST316 2740SQ.CM SCR130MIC F/6"MT	1	Various
10	700101-000484	Perforated ST316 Screen 3500 Mic For 6" Metal	1	Various
11	710102-000219	Operating Handle 4"S-14"	1	S/ST 316L
12	710103-000740	Tightening Nut (4"S-14"BRUSH)	1	Brass
13	710103-000739	Plastic Bushing (4"S-14")	1	Delrin
14	710102-000130	Tee 2" BSPT For B/A Red	1	ST. 37-2
15	730104-000265	Ball Valve 2" F/F Nickel Coated	1	NICKEL COATED
16	760101-000447	Hex Bolt Full Thread M6x35 DIN933 S/St 304	1	S/ST 304
17	760102-000085	Hex Nut M6 DIN934	5	S/ST 316
18	780101-000975	Nut 3/4"BSP Plastic	1	PP
19	710101-000974	UNION NUT CLIP	1	PBT
20	760103-000094	Flat Washer M6 DIN125 S/ST316	2	S/ST 316
21	700190-001245	Clogging Indicator Assembly 1/4"BSP	1	Various
22	710103-000777	BUSHING GUIDE BRUSH AXIS 4"-14	1	Delrin
23	710102-000217	SPINDLE & FRAME 6" SHORT FOR MOLD SCREEN	1	S/ST 316L
24	760107-000053	Axis Locking Spring	1	S/ST 316L
25	710103-000749	PLASTIC BRUSH UNIT 260MM 8" FOR MLD SCRIN	2	PVC
26	760103-000109	Spring Washer M6 DIN127 S/ST316	1	S/ST 316
27	760101-000445	Hex Bolt Full Thrd M6x25 S/St316 DIN933	4	S/ST 316
28	700190-001363	Selling Rope 4mm L1779	0.22	Silicon
9.1	770104-000080	Hydraulic Seal AM-05	2	EPDM